



Castles

EASTBROOK WAY  
Adeyfield, Hemel Hempstead HP2 5UQ



# EASTBROOK WAY

## Adeyfield, Hemel Hempstead HP2 5UQ

**£350,000**  
(Freehold)



A well presented, MODERN TWO Double Bedroom Family Home, perfect for a First Time Buyer! Situated within walking distance of the Town Centre in this sought after Adeyfield location.

The property comprises: Entrance Hall, Cloakroom, Fitted Kitchen, Lounge, Conservatory, Private Rear Garden with Gated Rear Access, Ample Residence Parking & Visitors Spaces and a garage in a block.

The First Floor Boasts from Two lovely Sized Double Bedrooms both having Built in Wardrobes, and a well sized Family Bathroom.

Tenure: Freehold  
Council Tax Band: C  
EPC Rating: D

**Ground Floor**  
Approx. 36.7 sq. metres (394.9 sq. feet)

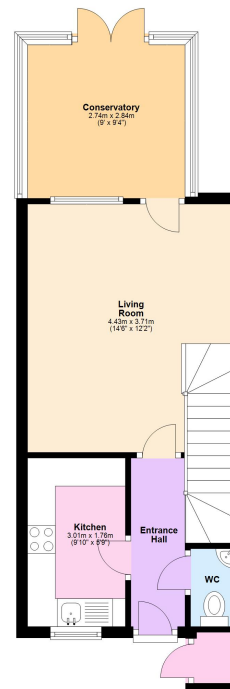

**First Floor**  
Approx. 28.5 sq. metres (307.0 sq. feet)

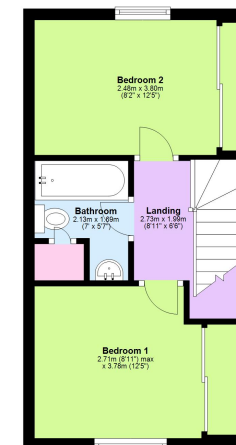

Total area: approx. 65.2 sq. metres (701.9 sq. feet)

This floorplan is not to scale. It's for guidance only and accuracy is not guaranteed.  
Plan produced using PlanUp.

**Please Note:**

We have not tested any apparatus, fixtures, fittings or services. Interested parties must undertake their own investigation into the working order of these items.

All measurements are approximate and photographs provided are for guidance only.

**Berkhamsted Office:** 148 High Street, Berkhamsted, Hertfordshire HP4 3AT **Tel: 01442 865252**  
**Boxmoor Office:** 33 St John's Road, Hemel Hempstead, Hertfordshire HP1 1QQ **Tel: 01442 233345**  
**Eaton Bray Office:** 2a Wallace Drive, Eaton Bray, Dunstable LU6 2DF **Tel: 01525 220605**  
**Kings Langley Office:** 1 High Street, Kings Langley, Hertfordshire WD4 8AB **Tel: 01923 936900**  
**Associated London Office:** 121 Park Lane, Mayfair, London W1K 7QG **Tel: 020 7079 1595**

[www.castlestateagents.co.uk](http://www.castlestateagents.co.uk)



# Castles