



Castles

ASTLEY ROAD
Boxmoor, Hemel Hempstead HP1 1HU

ASTLEY ROAD

Boxmoor, Hemel Hempstead HP1 1HU

£350,000 O.I.E.O
(Freehold)



A beautifully presented TWO BEDROOM, Terraced Cottage, situated just a few minutes' walk from Hemel Hempstead TOWN CENTRE with all of its amenities.

This property offers fantastic living accommodation throughout & two good size bedrooms, set over two floors. This must see property briefly comprises; Living Room/Dining Room, Fitted Kitchen, Fitted Bathroom, Two Bedrooms on the first floor, Double Glazing & Gas Central Heating, Private Rear Garden.

Tenure: Freehold
Council Tax Band: C
EPC Rating: C

Ground Floor
Approx. 28.8 sq. metres (310.2 sq. feet)

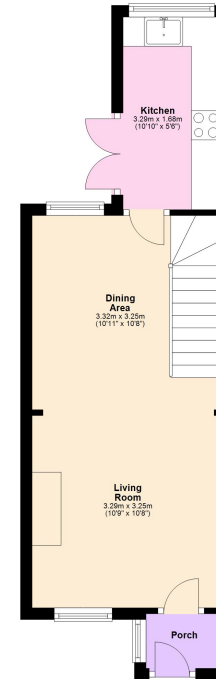

First Floor
Approx. 26.9 sq. metres (289.6 sq. feet)

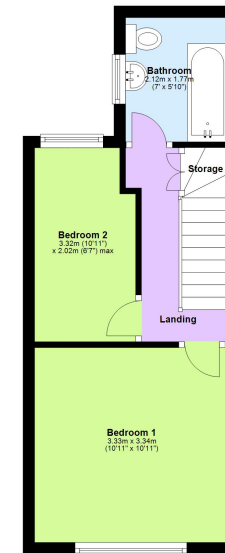

Total area: approx. 55.7 sq. metres (599.8 sq. feet)

This floorplan is not to scale. It's for guidance only and accuracy is not guaranteed.
Plan produced using PlanUp.

Please Note:

We have not tested any apparatus, fixtures, fittings or services. Interested parties must undertake their own investigation into the working order of these items.

All measurements are approximate and photographs provided are for guidance only.

Berkhamsted Office: 148 High Street, Berkhamsted, Hertfordshire HP4 3AT **Tel: 01442 865252**
Boxmoor Office: 33 St John's Road, Hemel Hempstead, Hertfordshire HP1 1QQ **Tel: 01442 233345**
Eaton Bray Office: 2a Wallace Drive, Eaton Bray, Dunstable LU6 2DF **Tel: 01525 220605**
Kings Langley Office: 1 High Street, Kings Langley, Hertfordshire WD4 8AB **Tel: 01923 936900**
Associated London Office: 121 Park Lane, Mayfair, London W1K 7QG **Tel: 020 7079 1595**

www.castlestateagents.co.uk



Castles