



Castles

SHEARWATER ROAD
Aspen Park, Hemel Hempstead HP3 0GB

SHEARWATER ROAD

Aspen Park, Hemel Hempstead HP3 0GB

£425,000 O.I.E.O
(Freehold)



The front of the house offers a well-appointed kitchen with plenty of space for all appliances, worktops and storage, while the living and dining areas inspire a sense of comfort and style. There is also the benefit of a downstairs WC.

The back of the house takes you out through double doors to a private garden with lawn, full fencing and a delightful garden room which is ideal for hobbies, working from home or extra storage. Outside to the rear also offers residents parking, perfect for ensuring a place for vehicles.

Upstairs offers two good sized double bedrooms, both served by a bright and light bathroom with shower over the bath and storage space.

This charming and inviting property offers a homely and comfortable living environment which has been maintained to the highest standards.

Tenure: Freehold
Council Tax Band: C
EPC Rating: C

Ground Floor
Main area: approx. 36.8 sq. metres (395.8 sq. feet)
Plus outbuildings, approx. 3.8 sq. metres (40.8 sq. feet)

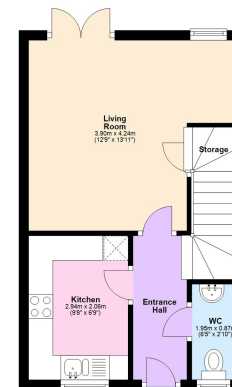
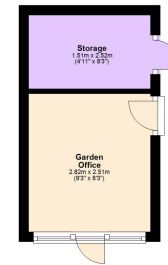

First Floor
Approx. 28.8 sq. metres (309.7 sq. feet)

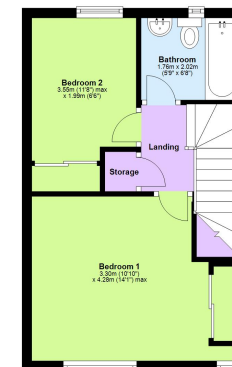

Main area: Approx. 65.5 sq. metres (705.5 sq. feet)
Plus outbuildings, approx. 3.8 sq. metres (40.8 sq. feet)

This floorplan is not to scale. It's for guidance only and accuracy is not guaranteed.
Plan produced using PlanUp.

Please Note:

We have not tested any apparatus, fixtures, fittings or services. Interested parties must undertake their own investigation into the working order of these items.

All measurements are approximate and photographs provided are for guidance only.

Berkhamsted Office: 148 High Street, Berkhamsted, Hertfordshire HP4 3AT **Tel: 01442 865252**
Boxmoor Office: 33 St John's Road, Hemel Hempstead, Hertfordshire HP1 1QQ **Tel: 01442 233345**
Eaton Bray Office: 2a Wallace Drive, Eaton Bray, Dunstable LU6 2DF **Tel: 01525 220605**
Kings Langley Office: 1 High Street, Kings Langley, Hertfordshire WD4 8AB **Tel: 01923 936900**
Associated London Office: 121 Park Lane, Mayfair, London W1K 7QG **Tel: 020 7079 1595**

www.castlestateagents.co.uk



Castles