



Castles

PRIORY COURT
Berkhamsted, HP4 2DP

PRIORY COURT

Berkhamsted, HP4 2DP

£350,000
(Leasehold)



This stunning upper floor flat in the heart of Berkhamsted offers a unique opportunity to enjoy picturesque views over the town, ensuring you're always in touch with the bustling life of the area. The property boasts a range of attractive features, making it an ideal living space for individuals, couples, or small families.

Upon entering the flat, you are welcomed by a spacious entrance hall that sets the tone for the rest of the property. The flat features two generously-sized double bedrooms, both equipped with fitted wardrobes. These bedrooms provide ample storage space while ensuring a cozy and organized living environment. The highlight of this property is the large, newly fitted kitchen. Equipped with modern appliances, it provides the perfect setting for culinary creativity. Whether you're an experienced cook or simply enjoy the convenience of a well-equipped kitchen, this space has you covered. The modern white shower room is fully tiled, combining aesthetics with functionality. The sleek design and attention to detail create a refreshing and rejuvenating experience. The expansive living/dining room is flooded with natural light from its triple aspect windows. This space serves as the heart of the flat, offering a comfortable area for relaxation, entertainment, and dining.

Residents can take advantage of the communal gardens, providing a tranquil outdoor space to unwind, read, or enjoy a picnic. The property offers the convenience of resident parking, ensuring that you always have a dedicated space for your vehicle.

Tenure: Leasehold
Council Tax Band: C
EPC Rating: TBC

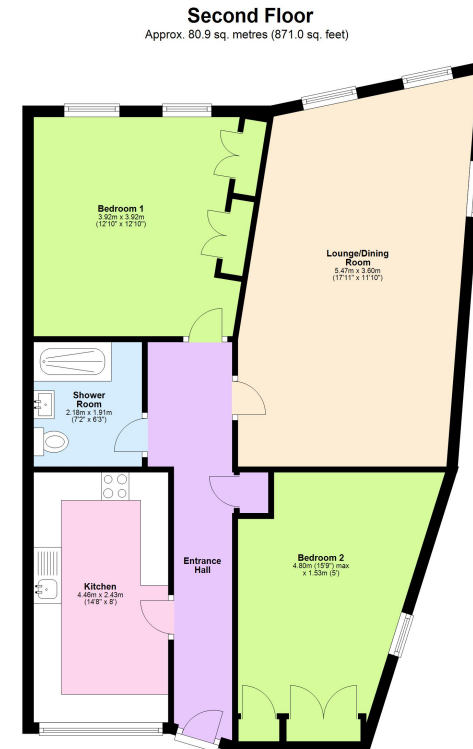

Total area: approx. 80.9 sq. metres (871.0 sq. feet)

This floorplan is not to scale. It's for guidance only and accuracy is not guaranteed.
Plan produced using PlanUp.

Please Note:

We have not tested any apparatus, fixtures, fittings or services. Interested parties must undertake their own investigation into the working order of these items.

All measurements are approximate and photographs provided are for guidance only.

Berkhamsted Office: 148 High Street, Berkhamsted, Hertfordshire HP4 3AT **Tel: 01442 865252**
Boxmoor Office: 33 St John's Road, Hemel Hempstead, Hertfordshire HP1 1QQ **Tel: 01442 233345**
Eaton Bray Office: 2a Wallace Drive, Eaton Bray, Dunstable LU6 2DF **Tel: 01525 220605**
Kings Langley Office: 1 High Street, Kings Langley, Hertfordshire WD4 8AB **Tel: 01923 936900**
Associated London Office: 121 Park Lane, Mayfair, London W1K 7QG **Tel: 020 7079 1595**

www.castlestateagents.co.uk



Castles